



Instinct Guides You



## Brunel Drive, Preston, Weymouth Offers In Excess Of £475,000

- Versatile Split Level Family Home
- Attractive Wrap Around Garden
- Far Reaching Views Towards Weymouth Bay
- Garage & Ample Parking
- Conservatory
- Close To Bus Route
- Desirable Area In Preston
- Shops & Amenities Nearby



Registration No. 08079158 Directors Mr Wilson, Mr Tominey

Courtesy Notice Upon using WilsonTominey as selling agents ensure we are made aware of contractual obligations you may be under. We can then proceed accordingly.

WilsonTominey Ltd  
15 Westham Rd.  
DT4 8NS

T 01305 775500  
E sales@wilsontominey.co.uk  
W www.wilsontominey.co.uk



Positioned on a generous corner plot, this tastefully updated split-level residence blends stylish interiors with thoughtful design across three versatile levels. The home enjoys an elevated position with attractive far reaching views and a wrap around mature garden.

From the moment you enter through the front porch, a bright and inviting hallway sets the tone, leading to two spacious double bedrooms (Bedrooms 2 and 3), along with staircases connecting both the upper and lower floors.

On the lower ground level, the main bedroom suite (Bedroom 1) offers a peaceful retreat, complete with a dressing space, fitted wardrobes, and a sleek en-suite shower room. Bedroom 4 enjoys direct access to a charming conservatory, which in turn opens onto the garden—perfect for quiet mornings and adds an element of versatility.

At the top of the house, the first-floor living area is bathed in natural light thanks to dual-aspect windows. Generously proportioned, it's ideal for both everyday living and entertaining, enhanced by a feature wall-mounted fire. The adjoining kitchen/diner is well-equipped with contemporary cabinetry, an integrated oven and hob, and space for further freestanding appliances. A window frames partial sea views, adding a calming backdrop. A neatly presented family bathroom completes the floor.

Outdoor Highlights

The block-paved driveway, accessed via a gated entrance, offers plenty of off-road parking and leads to a detached garage with power, lighting, and an electric roller door. The front garden bursts with character, offering mature planting, a lawn, and a pond, while a side deck provides elevated views over the nearby hills towards the sea.

To the rear, a raised deck and impressive summer house capture long-ranging views. Steps lead down to a manicured lawn dotted with colourful beds, shrubs, and trees—a truly private and tranquil garden setting.

Room Dimensions

Living Room 18'5" x 11'10" (5.62 x 3.62)

Kitchen 12'9" x 9'0" (3.91 x 2.75)

Bathroom 8'11" x 5'7" (2.72 x 1.71)

Bedroom Three 12'1" x 11'4" (3.69 x 3.46)

Bedroom Two 12'10" x 8'0" (3.92 x 2.45)

Bedroom One 11'10" x 9'1" (3.62 x 2.78)

Dressing Room 6'0" x 4'11" (1.83 x 1.51)

En-Suite 4'11" x 4'11" (1.52 x 1.5)

Bedroom Four 8'11" x 8'6" (2.73 x 2.61 )

Conservatory 12'0" x 8'10" (3.68 x 2.71)

Cellar 12'11" x 9'1" (3.96 x 2.78)

Garage 22'2" x 8'3" (6.78 x 2.53)

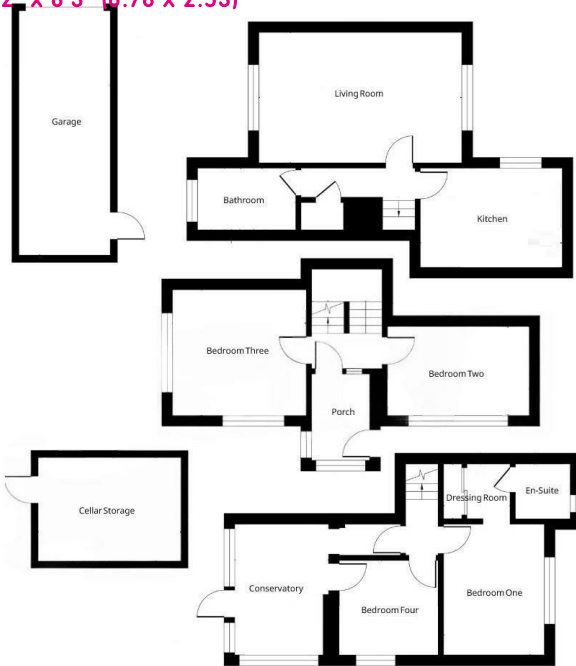

Energy Efficiency Rating		
	Current	Potential
Very energy efficient - lower running costs		
(92 plus) A		84
(81-91) B		
(69-80) C		71
(55-68) D		
(39-54) E		
(21-38) F		
(1-20) G		
Not energy efficient - higher running costs		
England & Wales		
EU Directive 2002/91/EC		

Environmental Impact (CO <sub>2</sub> ) Rating		
	Current	Potential
Very environmentally friendly - lower CO <sub>2</sub> emissions		
(92 plus) A		
(81-91) B		
(69-80) C		
(55-68) D		
(39-54) E		
(21-38) F		
(1-20) G		
Not environmentally friendly - higher CO <sub>2</sub> emissions		
England & Wales		
EU Directive 2002/91/EC		

Important Notice: Particulars are prepared for marketing purposes only and should not be treated as a statement of the condition of any building, fixture or appliance. All measurements, floor plans and lease/ maintenance are approximate and not to be relied upon. Purchasers should make their own checks before relying on any of the information provided herein. \* For double glazing and gas radiator heating, it is where specified.